

HISTORIC RESOURCES INVENTORY

Ser. No. 5120  
 HABS \_\_\_\_\_ HAER \_\_\_\_\_ Loc \_\_\_\_\_ SHL No. \_\_\_\_\_ NR Status 4  
 UTM: A10 / 10N 9E 18. 4492N 1 C \_\_\_\_\_  
 E \_\_\_\_\_ D \_\_\_\_\_

IDENTIFICATION

1. Common name: Driscoll House
2. Historic name: Dennis and Julia Driscoll House
3. Street or rural address: 1000 Green Valley Road Eureka Canyon  
 City Watsonville Zip 95076 County Santa Cruz
4. Parcel number: 10923224
5. Present Owner: Pohorski, George & Antoinette Address: 1000 Green Valley Road  
 City Watsonville Zip 95076 Ownership is: Public \_\_\_\_\_ Private X
6. Present Use: Residence Original use: Residence

DESCRIPTION

- 7a. Architectural style: W.W. Weeks Farm House
- 7b. Briefly describe the present physical appearance of the site or structure and describe any major alterations from its original condition:

The site consists of a rather large, square two story wooden farm house constructed on a rectangular plan and designed in a Colonial Revival style. The structure is dominated by a low hipped roof sheathed in composition shingles with a very low pitched eyebrow dormer facing the entry facade. Narrow ship lap sheathes the structure's exterior walls. The building rests on a concrete foundation. An angles bay window which is very shallow covers one side of the street facade. The most distinctive feature of the building is the wide front porch which is covered by a full pedimented portico and supported by tall and narrow square wooden columns. Fenestration is simple, rectangular in shape and generally double hung. The bay's central window exhibits a large plate glass window with narrow horizontal window above. The main entrance consists of a large wooden front door with a big glass pane surrounded by two narrow sidelights above wood panels. The structure is in fair condition. Landscape is mature, extensive and adequately maintained. Little alterations have been added to the residence. A detached garage/carriage house is located behind the building.



Construction date: Estimated \_\_\_\_\_ Factual 1904  
 Architect William Weeks  
 Builder Unknown  
 Approx. property size (in feet)  
 Frontage 143 Depth 145  
 or approx. acreage \_\_\_\_\_  
 Date(s) of enclosed photograph(s) May 1900

13. Condition: Excellent \_\_\_ Good ✓ Fair \_\_\_ Deteriorated \_\_\_ No longer in existence \_\_\_
14. Alterations: None known
15. Surroundings: (Check more than one if necessary) Open land \_\_\_ Scattered buildings \_\_\_ Densely built-up \_\_\_  
Residential ✓ Industrial \_\_\_ Commercial \_\_\_ Other: \_\_\_
16. Threats to site: None known \_\_\_ Private development \_\_\_ Zoning \_\_\_ Vandalism \_\_\_  
Public Works project \_\_\_ Other: \_\_\_
17. Is the structure: On its original site? ✓ Moved? \_\_\_ Unknown? \_\_\_
18. Related features: \_\_\_

**SIGNIFICANCE**

19. Briefly state historical and/or architectural importance (include dates, events, and persons associated with the site.)

The strawberry industry is of major importance in the agriculture of the Pajaro Valley region. The area has become famous for its fine crops. One of the best known strawberry types is the "Banner" brand berry. This strawberry was originated in 1904 by Dennis J. Driscoll and J.E. Reiter. The strawberry which they developed was particularly well suited to packaging and long distance transportation to the profitable East Coast markets. It became of even greater economic importance with the rise of frozen food processing after World War II. Driscoll's Banner brand has become essential to Santa Cruz County agriculture. In 1904, D.J. Driscoll decided to build his family home at 1000 Green Valley Road. He turned to influential architect William H. Weeks to design the house. Weeks was responsible for many important structures in turn of the century Santa Cruz County. In Watsonville, he planned the known "Old Tuttle House", Ford's Department Store and St. Patrick's Church. The current resident is Mr. George Pohorski.

20. Main theme of the historic resource: (If more than one is checked, number in order of importance.)  
Architecture 2 Arts & Leisure \_\_\_  
Economic/Industrial 1 Exploration/Settlement \_\_\_  
Government \_\_\_ Military \_\_\_  
Religion \_\_\_ Social/Education \_\_\_

21. Sources (List books, documents, surveys, personal interviews and their dates).  
Sanborn Maps 1908  
Historical Museum Files  
Watsonville Register Pajaronian  
A Field Guide to American Houses, McAlister  
*Betty Lewis, Historian*

22. Date form prepared April 1986  
By (name) The Firm of  
Organization BONNIE I. CAMBRIDGE  
Address: 247 W. Third Street  
City San Jose, CA 95128  
Phone: (408) 971-1421

Additional Sources:  
Zalia Kennedy, Marilyn McLachlan

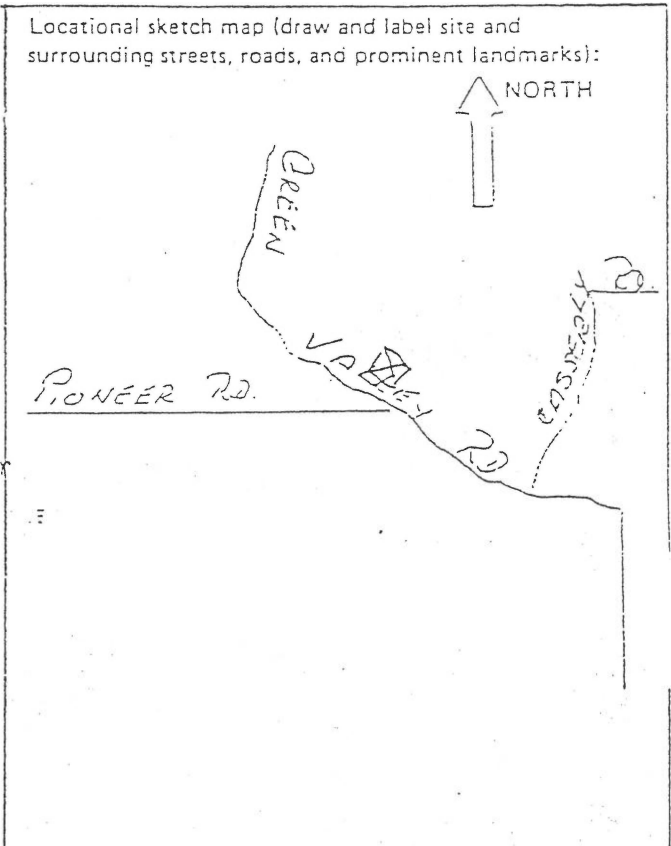

Driscoll House (1000 Green Valley Rd.)

ADDENDUM—1994

PHYSICAL INSPECTION

Date: April 31, 1994

Result of Inspection: No change.

CONSULTANT'S PRELIMINARY RECOMMENDATIONS:

No change.

(Change of rating pending public hearing before the Historical Resources Commission with final approval by the Board of Supervisors).

Context: 1 (agriculture)

Property type: Farm house